

RL20001 S-Beam, Alloy Steel, NTEP Single Cell, IP67 1:5000 III/1:10,000 IIII

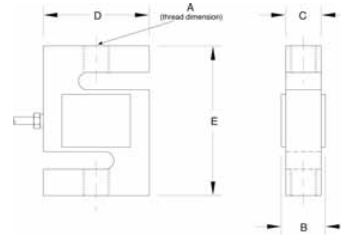

Picture is a representation of actual product



SPECIFICATIONS

Full Scale Output: 3.0 mV/V	Seal Type: Environmentally sealed, IP67	Insulation Resistance: 5000 megohms	Warranty: Two-year limited warranty
Output Resistance: 350 ohms, +/- 3	Safe Overload: 150% Full scale	Cable Length: 20 ft/6.1 m	Approvals: FM APPROVED, IEC, CE
Input Resistance: 385 ohms, +/- 5	Rated Excitation: 10V AC/DC (15V max.)	Cable Diameter: 200 polyurethane jacket	
Material/Finish: High-alloy steel, nickel plated	Nonlinearity: 0.03% Full scale	Cable Color Code: Red + Excitation Black - Excitation Green + Signal White - Signal	
Temperature: Compensated range 14°F to 104°F/-10°C to 40°C	Hysteresis: 0.02% Full scale		

DIMENSIONS

RATED CAPACITY	A	B	C	D	E
lb/inches					
250	3/8-24 UNF-2B	.75	.50	2.00	3.00
500-2000	1/2-20 UNF-2B	1.00	.75	2.00	3.00
2500-3000	1/2-20 UNF-2B	1.25	1.00	2.00	3.00
5000	3/4-16 UNF-2B	1.25	1.00	3.00	4.25
10,000	3/4-16 UNF-2B	1.25	1.00	3.50	4.75
15,000	1-14 UNF-2B	1.50	1.25	4.00	5.50
20,000	1 1/4-12 UNF-2B	2.25	2.00	5.00	7.00
kg/mm					
113.4	3/8-24 UNF-2B	19.1	12.7	50.8	76.2
226.8-907.2	1/2-20 UNF-2B	25.4	19.1	50.8	76.2
1134.0-1360.8	1/2-20 UNF-2B	31.8	25.4	50.8	76.2
2268.0	3/4-16 UNF-2B	31.8	25.4	76.2	108.8
4535.9	3/4-16 UNF-2B	31.8	25.4	88.9	120.7
6803.9	1-14 UNF-2B	38.1	31.8	101.6	139.7
9071.9	1 1/4-12 UNF-2B	57.2	50.8	127.0	177.8

ORDER INFORMATION

LOAD RATING	PART #	PRICE
250 lb (113.4 kg)	21402	Consult
500 lb (226.8 kg)	21403	Consult
750 lb (340.2 kg)	21404	Consult
1000 lb (453.6 kg)	21405	Consult
1500 lb (680.4 kg)	21406	Consult
2000 lb (907.2 kg)	21407	Consult
2500 lb (1134.0 kg)	21408	Consult
3000 lb (1360.8 kg)	21409	Consult
5000 lb (2268.0 kg)	21410	Consult
10,000 lb (4535.9 kg)	21411	Consult
15,000 lb (6803.9 kg)	21412	Consult
20,000 lb (9071.9 kg)	21413	Consult
Conduit Adapter Kit*(must be factory installed to maintain warranty)		
3/8-24 Nipple	31533*	Consult
3/8-24 to 1/4-18 NPT	31534*	Consult

*Parts #31533 and #31534 must be installed together to form the Conduit Adapter Kit

INTERCHANGEABLE PRODUCTS

MANUFACTURER	MODEL	PAGE #
VPG® Celtron	STC	191
VPG Sensortronics	60001	297

WEIGH MODULE AVAILABLE

MANUFACTURER	MODEL	PAGE #
Rice Lake Weighing Systems	ITCM Isolated Tension Cell Mount	364

RICE LAKE WEIGHING SYSTEMS

